

# TDJ-5158BKF9

## Wall Mount Antenna

### Technical Sheet



#### Features

- Superior Performance
- Small Size, Low Profile
- Lightweight ABS Radome
- Indoor Used

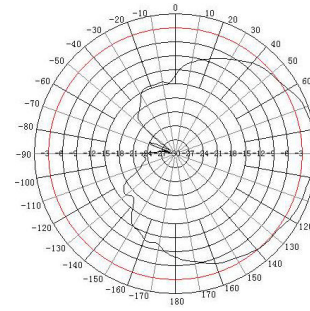

H-Plane

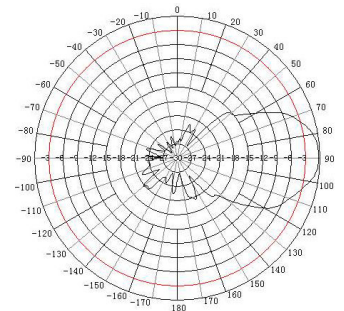

E-Plane

#### Specifications

Model	TDJ-5158BKF9
Freq. Range-MHz	5150~5850
Bandwidth-MHz	700
Gain-dBi	9.5
VSWR	≤1.8
F/B Ratio-dB	≥20
Beamwidth-°	E: 32 H: 73
Impedance-Ω	50
Polarization	Vertical
Max. Power-W	50
Connector Type	RP-TNC Male or Customization
Dimensions-mm	125×97×30
Weight-g	210
Fixing Way	Hung on the wall

#### Install Sketch

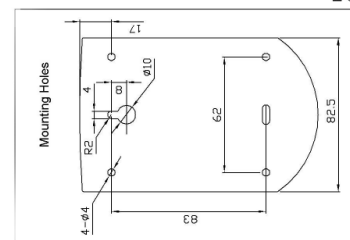
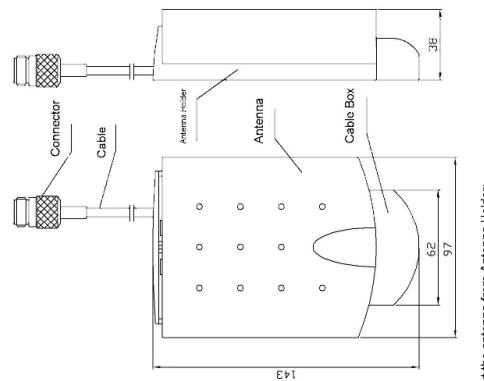

Notes:  
 1. Please cut the antenna from Antenna Holder.  
 2. Drill holes at the wall according to the maps.  
 3. Mounting the Antenna Holder to the wall.  
 4. Put the antenna to the Antenna Holder.



Kenbotong Communication LTD.

Addr: Kenbotong Technology Park, No.2 Chanxiu Road, Foshan, Guangdong, China 528061  
 Tel: +86-757-82219788, 82126632 Fax: +86-757-82212072  
 Email: kbt@kenbotong.com web: <http://www.kenbotong.com>